



Assembly Instructions

Sousaphone Holder

for a Wenger Student or Musician Chair

BEFORE YOU BEGIN

Read the complete assembly procedure before you start to assemble the holder.

Remove all items from the shipping cartons, and lay them out approximately in their final position. Refer to the parts list drawing below.

TOOLS REQUIRED

- 1/2" open-end or socket wrench:



FASTENERS USED FOR ASSEMBLY

- ④ Self-tapping screw:

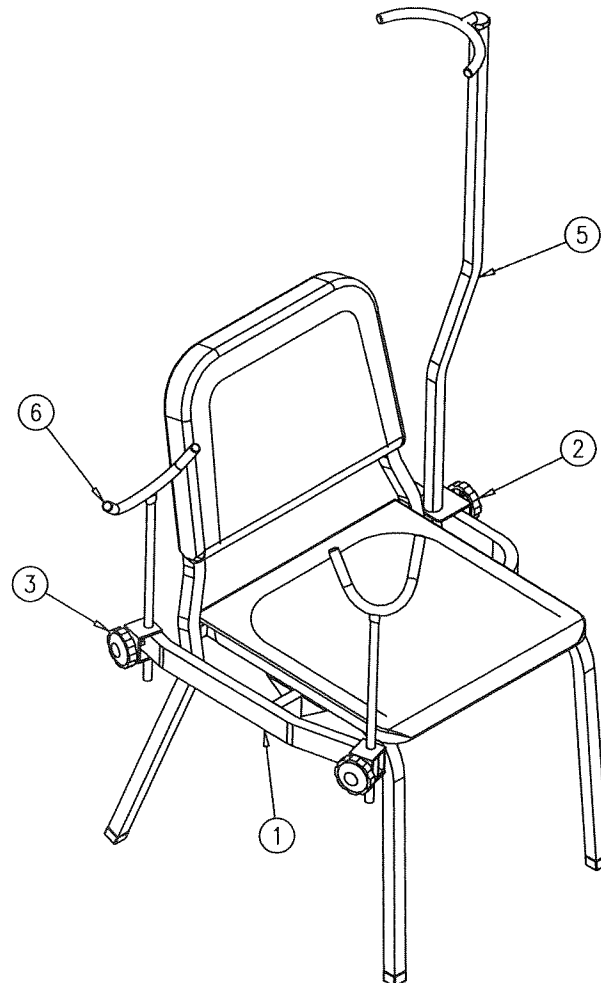
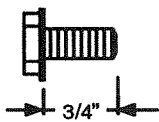

REPLACEMENT PARTS

Item	Description	Qty.
1	Frame	1
2	Clamp/knob, upper support arm	1
3	Clamp/knob, lower support arm	2
4	Screw, self-tapping, 3/4"	4
5	Arm, upper support	1
6	Arm, lower support	2

ASSEMBLY

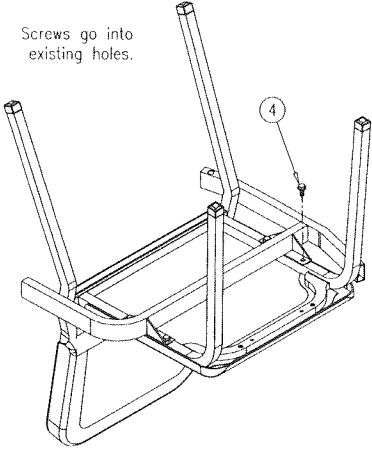

Screws go into existing holes.

1. Place the chair upside down on a table or bench.
2. Remove bumpers from front holes before beginning assembly (student chair only).
3. Attach the frame (1) to the underside of the chair. Use four self-tapping screws (4).
4. Tighten the screws with a wrench

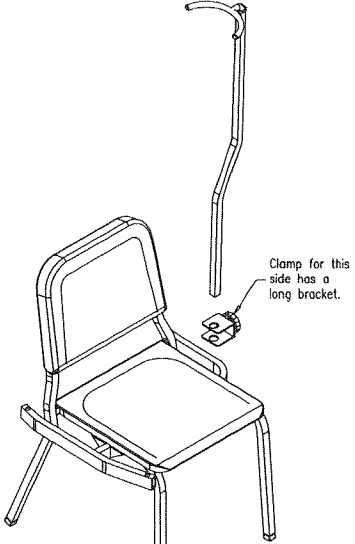

Clamp for this side has a long bracket.

5. Set the chair upright.
6. Slide the clamp (2) over the straight side of the frame.
7. Slide the upper support arm (5) through the holes in the clamp.
8. Tighten the knob just enough to hold the clamp in place.

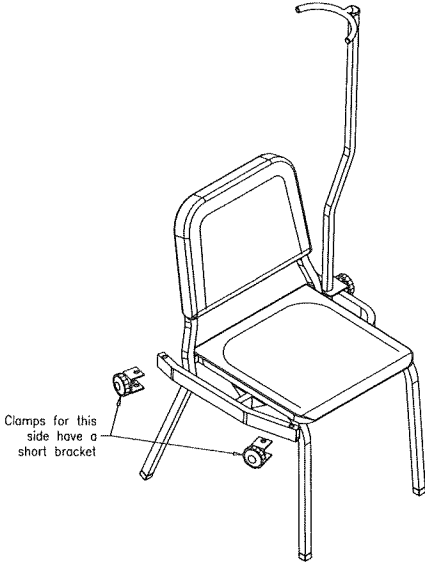

Clamps for this side have a short bracket

9. Slide the other two clamps (3) over the bent side of the frame.
10. Align the holes in the clamps with the holes in the frame.

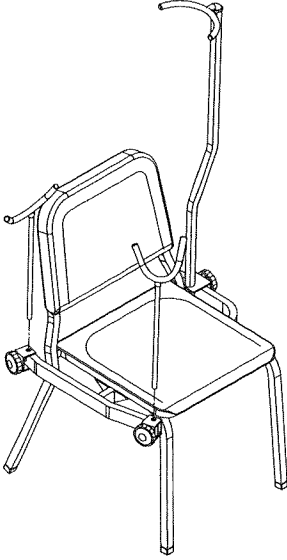

11. Slide a lower support arm (6) through one set of aligned holes. Tighten the knob to hold the arm in place. Repeat with the other lower support.

ADJUSTMENT

Two people are required to adjust the Holder.



Adjustment Notes

- When the holder is adjusted properly, the sousaphone will assume a natural balanced position.
- When you look at the sousaphone from the back, the large tapered tube (bell bow) just below the bell should be vertical. The upper instrument support on the holder should be positioned against the bell bow.
- Almost all sousaphones have one long lead-in pipe and two short pipes connecting the mouthpiece. Be sure they move freely, so the holder can be properly adjusted to individual players.
- Adjust the support arms so the instrument is raised just slightly above the shoulder of a player sitting upright in the chair. If the player is broad-shouldered and heavy, the lower supports can be raised and the upper one lowered, to give the player more room.

12. As a starting point, place the upper support arm's clamp about 2" from the rear end of the frame, and position the lower support arms so they extend about 2" below their clamps.
13. Place the sousaphone on the support brackets.
14. Make additional holder adjustments as required. See "Adjustment Notes" above.
15. To assume the playing position:
 - a. Sit on the front left corner of the chair.
 - b. With your left hand, move the instrument to the right, away from the upper support (resting its weight on the lower supports),
 - c. Lower your head, and slide into the playing position.
 - d. Allow the instrument to return to its original position.

ROUTINE MAINTENANCE

Frequently place a few drops of oil on the knob threads.

Replace damaged parts promptly.