

BEFORE YOU BEGIN

Read the complete assembly procedure before you start.

Remove all items from the shipping carton, and compare to the illustrations below.

TOOLS REQUIRED

- 1/2" open-end or socket wrench:

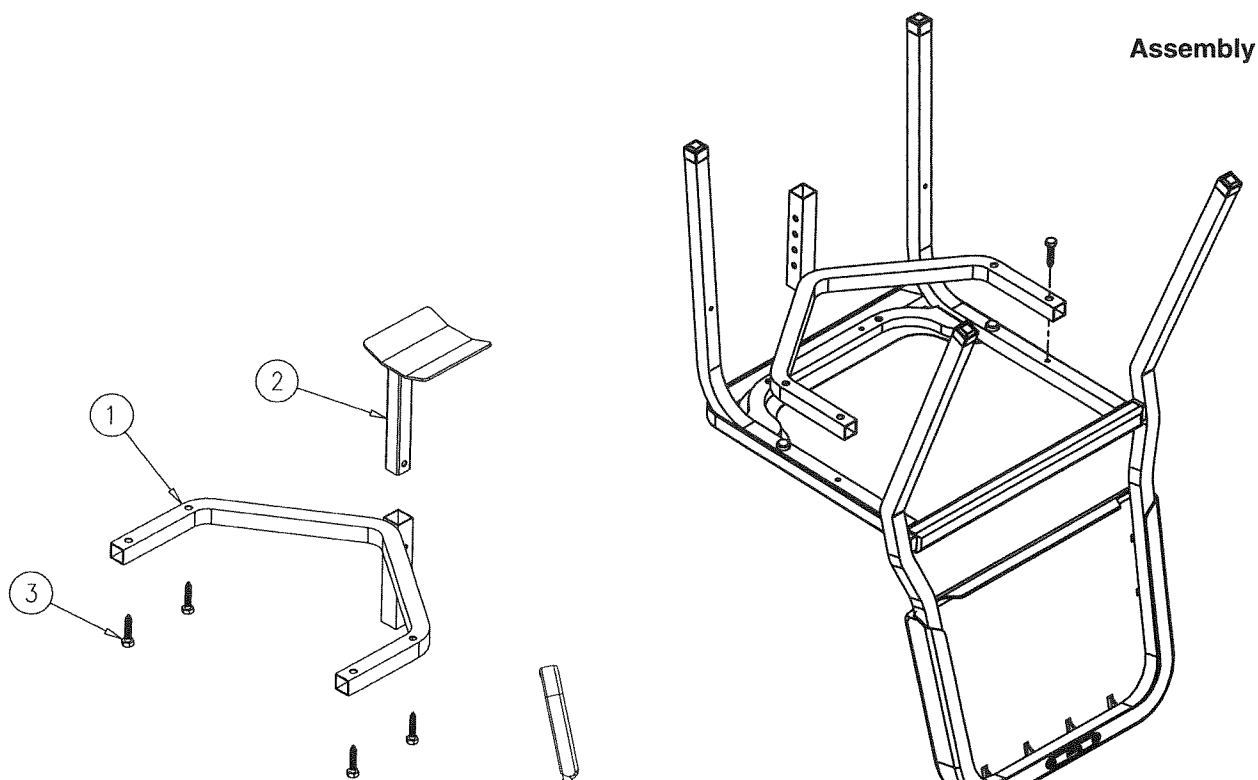

Assembly

REPLACEMENT PARTS

Item	Description
1	Base Assembly
2	Rest Assembly
3	Screw, self-tapping, 5/16 x 1-1/2"

Top plate of rest can face forward (as shown) or backward.

To adjust height of rest, position the snap button in appropriate hole.

1. Remove bumpers from front holes before beginning assembly (student chair only).
2. Attach the base (1) to the existing holes in the bottom of the chair. Tighten the screws.
3. Press the snap button, and slide the rest (2) into the base.