

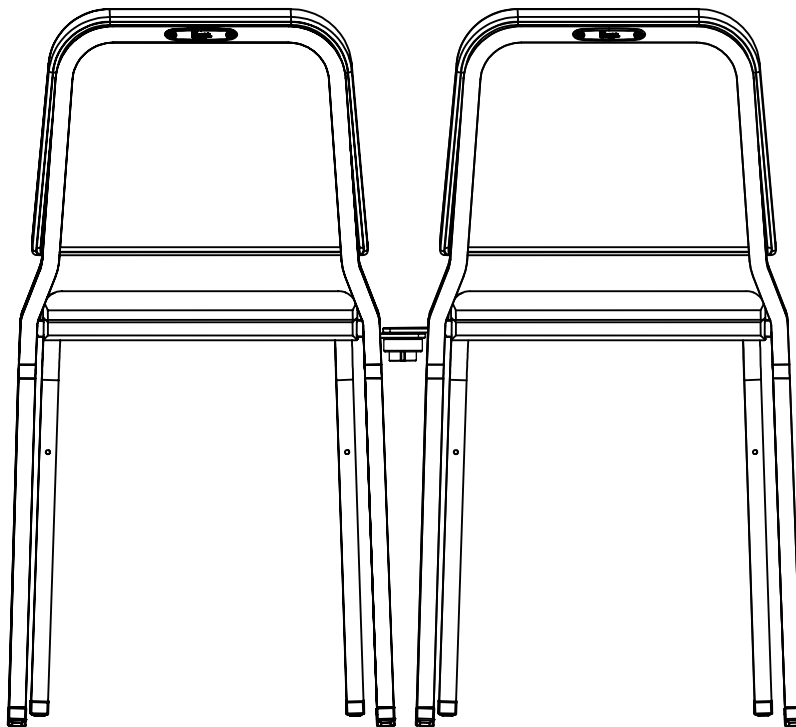

Assembly Instructions  
**Universal Ganging Clamp**  
**Accessory**  
 for Nota<sup>®</sup>, Student and Musician Chairs



Universal Ganging Clamp shown on Musician Chairs  
 (from the back)

## Contents

Important User Information . . . . .	2	Supplied Hardware . . . . .	3
Safety Precautions . . . . .	2	Assembly . . . . .	3
Required Tools . . . . .	3	Operation . . . . .	4



Visit the Nota Chairs web page at [wengercorp.com](http://wengercorp.com) for more information.

**Note:** Please read and understand these instructions before proceeding.  
**Note:** If you need additional information, contact Wenger Corporation using the information below.

# Important User Information

---

## General

Copyright © 2024 by Wenger Corporation

All rights reserved. No part of the contents of this manual may be reproduced, copied, or transmitted in any form or by any means including graphic, electronic, or mechanical methods or photocopying, recording, or information storage and retrieval systems without the written permission of the publisher, unless it is for the purchaser's personal use.

Printed and bound in the United States of America.

The information in this manual is subject to change without notice and does not represent a commitment on the part of Wenger Corporation. Wenger Corporation does not assume any responsibility for any errors that may appear in these instructions.

In no event will Wenger Corporation be liable for technical or editorial omissions made herein, nor for direct, indirect, special, incidental, or consequential damages resulting from the use or defect of these instructions. The manufacturer reserves the right to change this product at any time.

The information in this document is not intended to cover all possible conditions and situations that might occur. The end user must exercise caution and common sense when assembling or installing Wenger Corporation products. If any questions or problems arise, call the Wenger Corporation at (800) 4WENGER (493-6437) or +1-507-455-4100 worldwide.

## Manufacturer

The Sousaphone Holder Accessory is manufactured by:

Wenger Corporation  
555 Park Drive  
Owatonna, MN 55060  
(800) 4WENGER (493-6437) • +1 (507) 455-4100  
wengercorp.com

## Intended Use

- This product is intended for indoor use in normal ambient temperature and humidity conditions – it must not be exposed to prolonged outside weather conditions.
- This product is intended to be assembled and used only as described in these instructions.

## Warranty

Warranty information is available at [wengercorp.com](http://wengercorp.com).

# Safety Precautions

---

Throughout this document you may find cautions and warnings which are defined as follows:

- **WARNING:** Failure to follow the instruction could result in serious injury or damage to property.
- **CAUTION:** Failure to follow the instruction could result in minor injury or damage to property.

Read all of these safety instructions before using the equipment.

### **⚠ CAUTION**

***Make sure anyone assembling, installing or using this product has read and understands these instructions.***

### **⚠ CAUTION**

***Failure to comply with Warnings and Cautions in this document or on the equipment can result in damage to property or injury.***

## Required Tools

- Socket wrench or electric drill with 1/2" socket

## Supplied Hardware

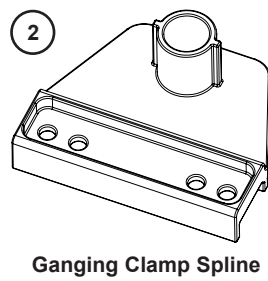
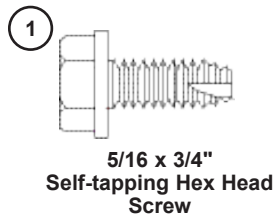

## Assembly

1. Place the chair upside down on a table or bench. Protect the chair by placing a pad or blanket on the work surface.
2. Pre-cut the ganging clamp mounting holes by threading, and then removing, the 5/16 x 3/4" self-tapping screws (1) into the pre-punched mounting holes on the bottom of the chair frame front legs.
3. Attach the ganging clamp spline (2) to the user's left side leg of the chair using two of the 5/16" x 3/4" self-tapping screws (1).

### NOTICE

**There are four mounting holes in the bracket.**

**The inner two holes are used for attaching the bracket to Nota Chairs.**

**The outer two holes are used for attaching the brackets to Student and Musician Chairs.**

4. Attach the ganging clamp receiver (3) to the user's right side leg of the chair in the same manner as step 2.
5. Place the chair right side up on the floor.

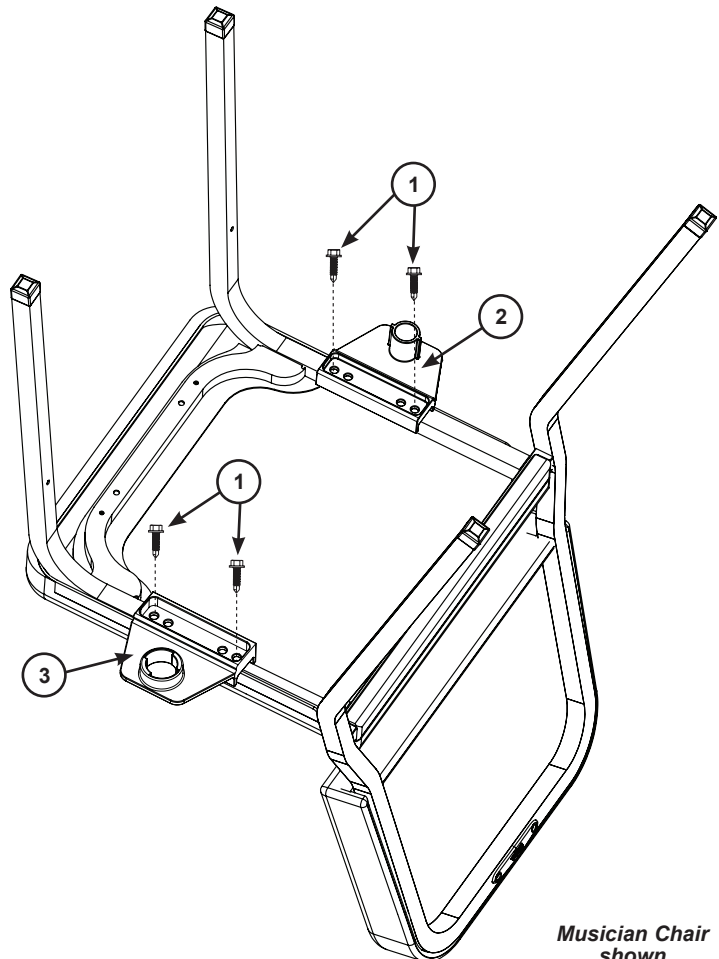

## Operation

---

1. To gang chairs together, lift a chair so that the spline side bracket can be positioned and inserted through the receiver hole of the adjacent chair.

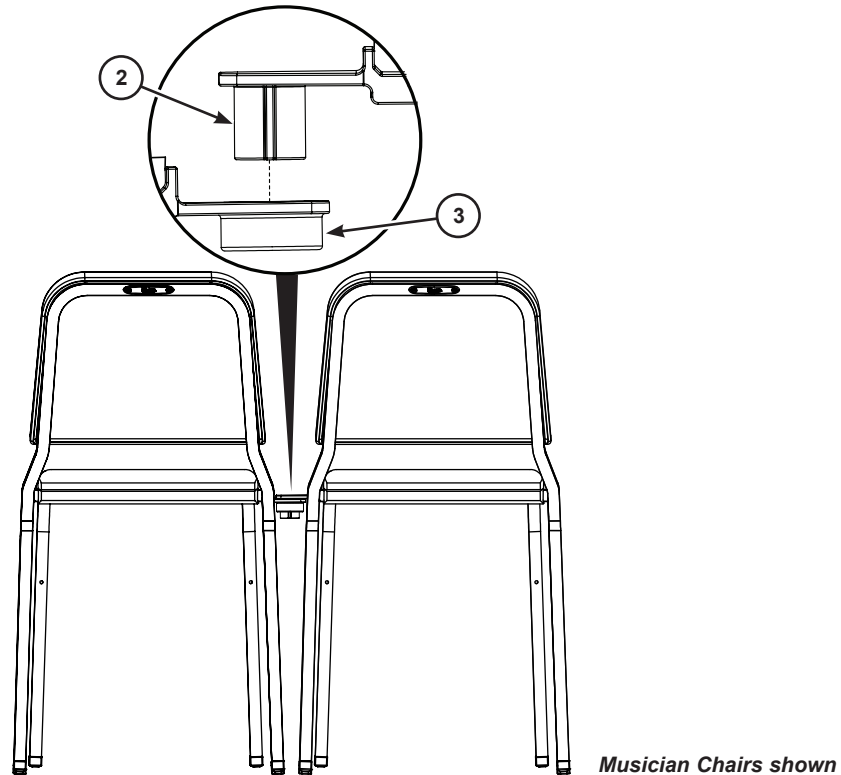

2. Configurations using the ganging brackets:
  - **Straight** - position the chairs in a straight row.
  - **Arc Angle** - position the chairs in any random arc angle up to the maximum when the front chair legs make contact. (Shown below)
  - **Reversed Arc** - to create a reverse arch, the ganging brackets must be mounted with the spline clamp (#2) on the right side and the receiver clamp on the left side.

